



## SECURISTAY SAFER WINDOW VENTILATION

PROFESSIONAL SERIES

### TOOLS REQUIRED

- Drill
- 2.5mm drill bit
- Pozi screwdriver
- Tape measure
- Safety goggles

### CONTENTS

- 1 x Securistay
- 1 x Sash plate
- 1 x Anti rattle strip
- 1 x Sash frame templates
- 5 x 6g x25mm screws

### FEATURES

- Lockable arm can be disengaged only when window is closed
- Safer window control in windy conditions
- Adjustable ventilation settings

P348W



## SECURI- STAY

SAFER WINDOW  
VENTILATION

PROFESSIONAL  
SERIES



### SAFER VENTILATION

Suitable for timber



Suitable  
for awning



Suitable  
for casement



Provides  
child safety



Deters  
unlawful entry



Easy  
install



Instructions  
included



Made in  
New Zealand

P348W  
Q25142 0818



9 414553 001345

ASSA ABLOY New Zealand  
6 Armstrong Road, Albany,  
Auckland 0632, New Zealand

Quality, ISO 9001  
Environmental, ISO 14001

For customer feedback:  
nzsales@assaabloy.com



PLEASE  
RECYCLE

**Yale** The world's favourite lock  
[www.yalelock.co.nz](http://www.yalelock.co.nz)

An ASSA ABLOY Group brand

**ASSA ABLOY**



# Securistay

For safer window ventilation

Awning  
Windows

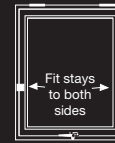

Casement  
Windows

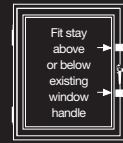

**Securistay P348:** For timber awning and casement windows.

**Operation:** Locating grooves allow for three different ventilation settings. Lockable arm can be disengaged (only when window is closed) to allow wider window opening.

**Finish:** White.

**Application:** Allows safer ventilation when house is occupied. When house is unoccupied, windows should be deadlocked with an appropriate Yale window lock.

2

### Drilling Screw Holes

- Drill 2.5mm holes in positions marked to a depth of 25mm

**Note:** Do not drill hole for lower sash plate screw at this stage.

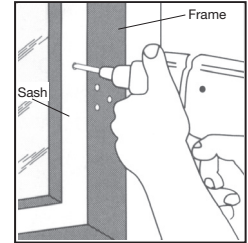

3

### Fixing Securistay

- Fit the anti-rattle strip now - See anti-rattle strip note below
- Screw the sash plate in place (through the top hole only), then screw the frame plate in place

**Note:** To allow extra clearance for the screwdriver when screwing in frame plate screws, locate the frame plate boss shaft in one of the locating grooves (refer components diagram).

- Check for correct installation and that arm can be disengaged (see note above)

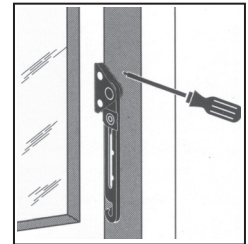

## Components

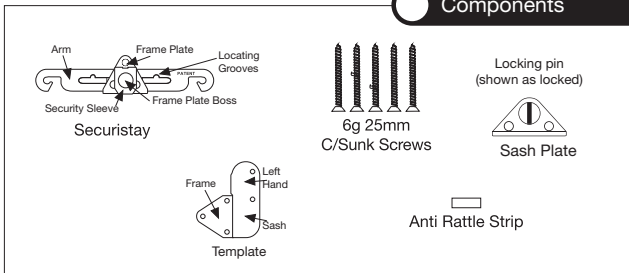

## Fixing Instructions

1

### Marking Location

#### Awning Window

- With window closed, mark position on vertical sash stile 180mm up from the sill
- Locate top of template on 180mm position.
- Mark screw hole positions

#### Casement Window

- With window closed, mark position on vertical sash stile below existing window handle (or above if insufficient clearance)
- Locate top of template on marked position.
- Mark screw hole positions

- **Locking pin on sash plate must be facing away from window frame as shown on diagram.**

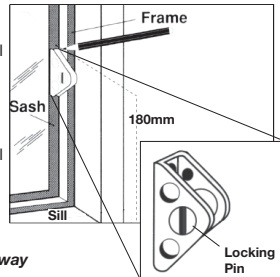

### Check arm can be disengaged

Close window, ensure locking pin is in vertical position, lift arm up. If installation is correct, arm should re-engage automatically when window is closed. Drill bottom hole for sash plate and screw in place.



### Security and Safety

For security, the Securistay can only be disengaged when window is tightly closed. For additional child safety and added security, and to prevent stay from being disengaged when window is closed, turn locking pin 90° with coin or flat head screwdriver.

### Anti Rattle Strip

An anti-rattle strip is provided and can be easily fitted by removing the film from the adhesive back of the strip and placing it on the inside of the sash plate between the screw holes.